

**Aerospace
Fluid Conveyance**

LJ11 and J11 Joints



LJ11 and J11 Joints

LJ11 and J11 Joints were designed primarily to join standard tubing for fuel, hot air and gas systems. The substitution of couplings other than the coupling part numbers specified for each joint can seriously impair the effectiveness of the joint. Although these joints are basically the same configurations, the LJ11 flange skirts

are lighter, and the gasket is thinner except at the sealing point. Therefore, the LJ11 Joint should be used when weight saving is an important factor. The J11 Joint is a heavier joint with a high safety factor.



Joint consists of one coupling, two flanges and an all-metal gasket.



Quick Coupler Latch can be connected or disconnected without removal of nut.



LJ11 Joint is available with T-Bolt Latch only. This latch is also used on the large sizes of the J11 Joint.

LJ11 and J11 Joint Specifications and Dimensions

Quick Coupler Latch Coupling

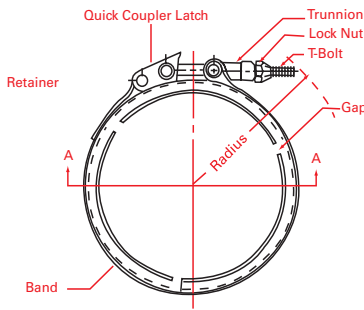

Band Width **.750** (19.05mm) for dias. **1.00** (25.4mm) through **2.75** (69.85mm)
.875 (22.23mm) for dias. **3.00** (76.2mm) through **5.50** (139.7)

Section A — A

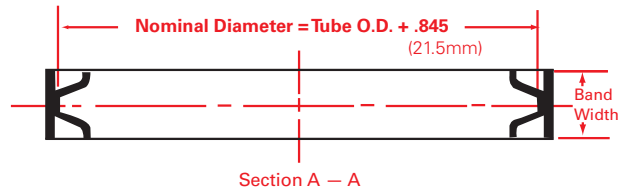

T-bolt Latch Coupling

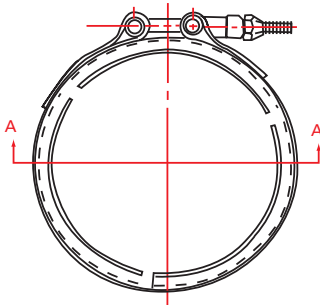

Band Width **.750** (19.05mm) for dias. **1.00** (25.4mm) through **5.00** (127mm)
1.125 (28.58) for dias. **6.00** (152.4mm) through **9.00** (228.66mm)

Joint

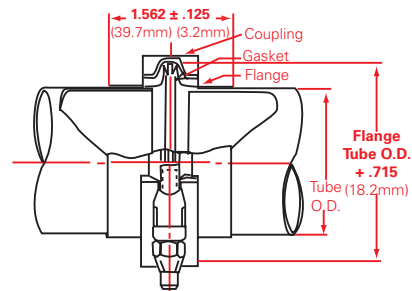

inches in boldface; mm in lightface

Order By Component Part Numbers

One coupling, one gasket and two flanges are required to make a complete joint. (T-Bolt and nut are furnished with coupling). Flange skirt thickness code must be added to complete the Flange Part Number, and gasket material code must be added to complete the Gasket Part Number.

Sample Flange Part No.: 16933-100-6 (one inch dia. for J11 Joint with .050 skirt thickness).

Sample Gasket Part No.: 17189-400-N (four inch dia. for J11 Joint with nickel material).

Replacement T-Bolts can be ordered for Quick Coupler Latches only. They cannot be replaced on T-Bolt Latches. Last dash number indicates T-Bolt length in hundredths inches.

Tolerances on recommended torque are $\pm 10\%$.

Gasket

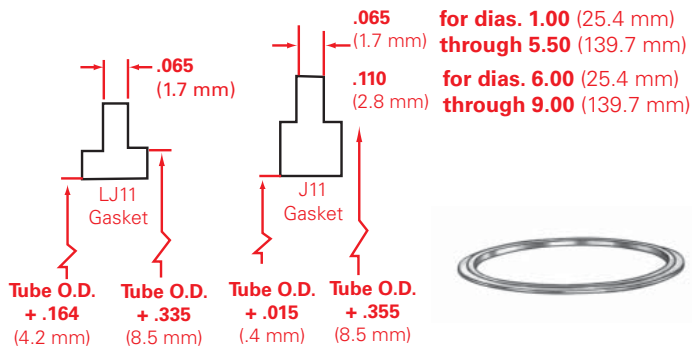

Flange

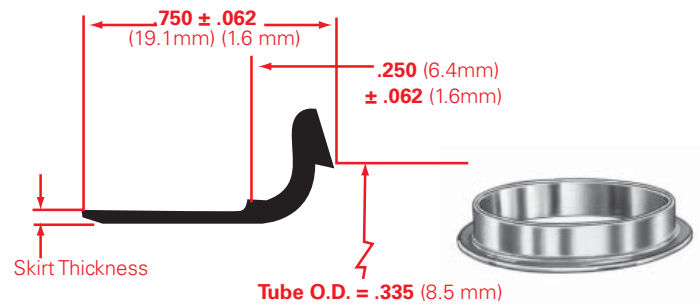

Gasket Material	Temperature	Material Ordering Code
Aluminum	+ 500°F + 260°C	-A
Copper (Nickel Plated)	+ 750°F + 399°C	-C
Nickel	+ 1000°F + 538°C	-N

If a joint is disassembled after service operations, a new gasket should be used when reassembled to ensure maximum sealing efficiency of the joint.

Tube Size O.D.	Skirt Thickness	Ordering Code
1.00 — 5.50 25.4 — 139.7	+ .005 (.030) — .010 +127 (.762) — .254	-3*
1.00 — 9.00 25.4 — 228.6	(.050) ± .010 (1.27) ± 2.54	-6
6.00 — 9.00 152.4 — 228.6	(.080) ± .010 (2.03) ± .254	-6

Inches in **bold** face type
 Millimeters in light face type

Performance Ratings for LJ11 and J11 Joints

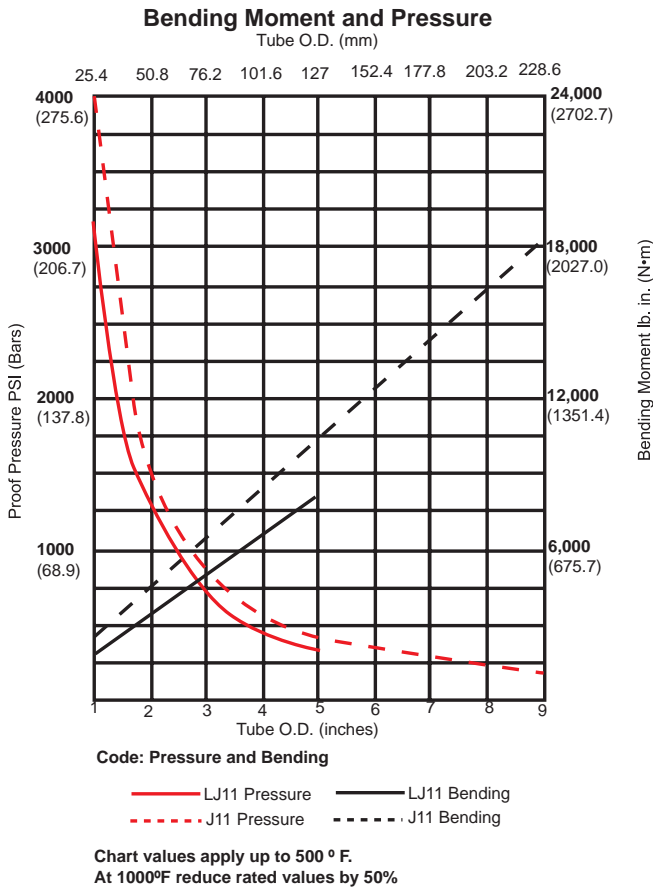

The two principal types of loading experienced in this type of joint are pressure and bending. The chart shown at the left is designed to help you determine the ability of the LJ11 or J11 Joint to withstand a given load or combination of loads.

Step 1. If there is only one type of loading, the joint capability may be easily determined. Draw a vertical line upward from the joint size on the bottom scale until it intersects the appropriate curve for joint* and type of loading.

Step 2. Draw a horizontal line from this intersection to the appropriate loading scale and read load rating. Adjust for temperature conditions by multiplying with the correction factor. Compare this with your design load to determine suitability of the joint.

Step 3. If a combined loading exists (bending and pressure) determine joint capabilities for each load separately as in Steps 1 and 2 above.

Step 4. Divide load rating into actual load condition for each type of loading, and express answer as a percent. Add percentage of load rating for each type of loading. If your answer is less than 100%, the difference represents your safety margin.

**If joint weight is a consideration, it is recommended that the LJ11 be checked against the applied conditions first. If the margin of safety is not satisfactory, then steps 1 through 4 may be repeated using the J11 curves.*

Example:

- 3.00 dia. joint to operate at 200° F.
- 300 psi proof pressure
- 2000 lb in. bending movement

Steps 1-3.

- Rated loads for LJ11 are as follows:
- 642 psi proof pressure @200°F.
- 4400 lb in. bending moment @200°F.

Step 4.

$$\frac{300}{642} = 46.7\% \text{ of pressure load rating}$$

$$\frac{2000}{4400} = 45.4\% \text{ of bending load rating}$$

Loads are 92.1% of joint capacity

Temperature	+ 70° F +21.1°C	+200°F +93°C	+400°F +204°C	+500°F +260°C	+600°F +316°C	+800°F +427°C
Correction	1.00	.88	.76	.73	.70	.63

Inches, lbs. and lb. - in. in **bold** face type
 Millimeters, kg. and N-m in light face type

		Coupling					Flange					Gasket				Weight each (lbs)		
Tube Size O.D.	Part Number	Weight each	Radius Max.	T-Bolt*		Recom- mended Torque	Part Number	Skirt Thick- ness Code (Specify One)			Weight Each	Part Number	Material Code (Specify One)			Alum.	Copper or Nickel	
				Part Number And Length	Thread													
T-Bolt Latch	1.00 25.4	18276-100	.177 .080	2.093 .949	* -200	10-32 UNJF -3A	50 5.65	16933-100	-3			.050 .022	24346-100	-A	-C	-N	.008 .003	.033 .014
	1.25 31.37	18276-125	.196 .088	2.187 .992	* -200		50 5.65	16933-125	-3			.058 .026	24346-125	-A	-C	-N	.010 .004	.038 .017
	1.50 38.1	18276-150	.217 .098	2.531 1.148	* -250		80 9.04	16933-150	-3			.071 .032	24346-150	-A	-C	-N	.012 .005	.045 .020
	1.75 44.45	18276-175	.250 .113	2.625 1.190	* -250		80 9.04	16933-175	-3			.083 .037	24346-175	-A	-C	-N	.014 .063	.050 .022
	2.00 50.8	18276-200	.348 .158	2.687 1.218	* -250	¼ - 28 UNJF -3A	80 9.04	16933-200	-3			.094 .042	24346-200	-A	-C	-N	.016 .007	.056 .025
	2.25 57.15	18276-225	.370 .167	3.093 1.402	* -275		115 12.99	16933-225	-3			.103 .046	24346-225	-A	-C	-N	.018 .008	.051 .023
	2.50 63.5	18276-250	.387 .171	3.125 1.417	* -275		115 12.99	16933-250	-3			.113 .051	24346-250	-A	-C	-N	.020 .009	.067 .030
	2.75 69.85	18276-275	.415 .190	3.400 1.542	* -300		115 12.99	16933-275	-3			.124 .056	24346-275	-A	-C	-N	.022 .010	.074 .033
	3.00 76.2	18276-300	.570 .258	3.562 1.615	* -300	¼ - 28 UNJF -3A	115 12.99	16933-300	-3			.137 .062	24346-300	-A	-C	-N	.024 .011	.078 .035
	3.50 88.9	18276-350	.624 .283	3.593 1.629	* -300		165 18.64	16933-350	-3			.158 .071	24346-350	-A	-C	-N	.028 .012	.091 .041
	4.00 10.16	18276-400	.688 .312	3.781 1.715	* -300		165 18.64	16933-400	-3			.180 .081	24346-400	-A	-C	-N	.032 .014	.102 .046
	4.50 114.3	18276-450	.752 .341	4.000 1.814	* -300		165 18.64	16933-450	-3			.215 .079	24346-450	-A	-C	-N	.036 .016	.114 .051
	5.00 127	18276-500	.825 .374	4.250 1.927	* -300	165 18.64	16933-500	-3			.223 .101	24346-500	-A	-C	-N	.038 .017	.126 .057	

* Replacement T-Bolts can be ordered for Quick Coupler Latches only. They can not be replaced on T-Bolt Latches. Last dash number indicates T-Bolt length in hundredths inches.

J11 Joints

Inches in **bold** face type
 Millimeters in light face type

	Coupling					Flange					Gasket			Weight each (lbs)				
	Tube Size O.D.	Part Number	Weight each	T-Bolt* Radius Max.	Part Number And Length	Thread	Recommended Torque	Part Number	Skirt Thickness Code (Specify One)		Weight Each	Part Number	Material Code (Specify One)		Alum.	Copper or Nickel		
Quick Coupler Latch	1.00 25.4	24502-100	.277 .125	2.125 .963	18462-75-250	1/4-28 UNJF -3A	70 7.91	16933-100	-3	-6	.061 † .027	17189-100	-A	-C	-N	.012 .005	.039 .017	
	1.25 31.37	24502-125	.293 .132	2.187 .992	18462-75-250		70 7.91	16933-125	-3	-6	.075 † .034	17189-125	-A	-C	-N	.015 .006	.050 .022	
	1.50 38.1	24502-150	.325 .147	2.500 1.133	18289-75-250		100 11.32	16933-150	-3	-6	.089 † .040	17189-150	-A	-C	-N	.017 .007	.058 .026	
	1.75 44.45	24502-175	.344 .156	2.562 1.162	18289-75-250		100 11.32	16933-175	-3	-6	.100 † .045	17189-175	-A	-C	-N	.020 .009	.070 .031	
	2.00 50.8	24502-200	.372 .166	2.875 1.304	18289-75-275		130 14.69	16933-200	-3	-6	.119 † .053	17189-200	-A	-C	-N	.022 .010	.073 .033	
	2.25 57.15	24502-225	.387 .175	2.937 1.332	18289-75-275		130 14.69	16933-225	-3	-6	.128 † .058	17189-225	-A	-C	-N	.024 .011	.087 .039	
	2.50 63.5	24502-250	.402 .182	3.062 1.388	18289-75-275		130 14.69	16933-250	-3	-6	.144 † .065	17189-250	-A	-C	-N	.028 .012	.098 .044	
	2.75 69.85	24502-275	.433 .196	3.187 1.445	18289-75-275		130 14.69	16933-275	-3	-6	.156 † .070	17189-275	-A	-C	-N	.031 .014	.110 .049	
T-Bolt Latch	3.00 76.2	24503-300	.775 .351	3.687 1.672	18289-75-350	5/16-24 UNJF -3A	220 24.86	16933-300	-3	-6	.172 † .078	17189-300	-A	-C	-N	.035 .015	.112 .050	
	3.50 88.9	24503-350	.835 .378	3.875 1.757	18448-88-350		220 24.86	16933-350	-3	-6	.208 † .094	17189-350	-A	-C	-N	.037 .016	.120 .054	
	4.00 101.6	24503-400	.895 .405	4.062 1.842	18448-88-350		220 24.86	16933-400	-3	-6	.226 † .102	17189-400	-A	-C	-N	.043 .019	.147 .066	
	4.50 114.3	24503-450	.960 .435	4.250 1.927	18448-88-350		240 27.12	16933-450	-3	-6	.268 † .121	17189-450	-A	-C	-N	.048 .021	.170 .077	
	5.00 127	24503-500	1.030 .467	4.437 2.012	18448-88-350		240 27.12	16933-500	-3	-6	.290 † .131	17189-500	-A	-C	-N	.053 .024	.180 .081	
	5.50 139.7	24503-550	1.080 .488	4.625 2.097	18448-88-350		240 27.12	16933-550	-3	-6	.320 † .145	17189-550	-A	-C	-N	.059 .026	.210 .095	
	6.00 152.4	24504-600	1.633 .740	5.125 2.324	* -400		280 31.64	24249-600		-6	-8	.449 † .203	24189-600	-A	-C	-N	.090 .040	.317 .143
	7.00 177.8	24504-700	1.793 .813	5.500 2.494	* -400		280 31.64	24249-700		-6	-8	.507 † .229	24189-700	-A	-C	-N	.107 .048	.386 .175
8.00 203.2	24504-800	2.005 .910	5.937 2.692	* -400	300 33.90	24249-800		-6	-8	.565 † .256	24189-800	-A	-C	-N	.125 .056	.432 .195		
9.00 228.6	24504-900	2.190 .993	6.375 2.891	* -400	300 33.90	24249-900		-6	-8	.623 † .282	24189-900	-A	-C	-N	.140 .063	.477 .216		

* Replacement T-Bolts can be ordered for Quick Coupler Latches only. They can not be replaced on T-Bolt Latches. Last dash number indicates T-Bolt length in hundredths inches.

† Weight is for largest Flange size

Assembly of LJ11 and J11 Joints To Machined Flange

Inches in **bold** face type
Millimeters in light face type

Tube Size O.D.	Part Number	Special Gasket Material Code (Specify One Only)			A Max	L Min.	Tube Size O.D.	Part Number	Special Gasket Material Code (Specify One Only)			A Max	L Min
1.00 25.4	24096-100	-A	-C	-N	1.135 .514	.515 .233	3.50 88.9	24096-350	-A	-C	-N	3.635 1.648	.593 .268
1.25 31.37	24096-125	-A	-C	-N	1.385 .628	.515 .233	4.00 10.16	24096-400	-A	-C	-N	4.135 1.875	.593 .268
1.50 38.1	24096-150	-A	-C	-N	1.635 .741	.515 .233	4.50 114.3	24096-450	-A	-C	-N	4.635 2.102	.593 .268
1.75 44.45	24096-175	-A	-C	-N	1.885 .855	.515 .233	5.00 127.00	24096-500	-A	-C	-N	5.135 2.329	.593 .268
2.00 50.8	24096-200	-A	-C	-N	2.135 .968	.515 .233	5.50 139.7	24096-550	-A	-C	-N	5.635 2.555	.593 .268
2.25 57.15	24096-225	-A	-C	-N	2.385 1.081	.515 .233	6.00 152.4	24096-600	-A	-C	-N	6.170 2.798	.718 .325
2.50 63.5	24096-250	-A	-C	-N	2.635 1.195	.515 .233	7.00 177.8	24096-700	-A	-C	-N	7.170 3.252	.718 .325
2.75 69.85	24096-275	-A	-C	-N	2.885 1.308	.515 .233	8.00 203.2	24096-800	-A	-C	-N	8.170 3.705	.718 .325
3.00 76.2	24096-300	-A	-C	-N	3.135 1.422	.593 .268	9.00 228.6	24096-900	-A	-C	-N	9.170 4.159	.718 .325

Order by Part Number

Material Code must be added to complete the Gasket Part Number.

Sample Part number.: 24096-400-C (four inch dia. with copper material)

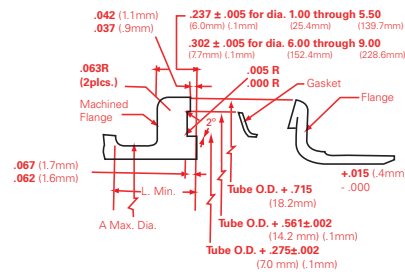

LJ11 or J11 Flanges and Couplings are to be used to complete the joint

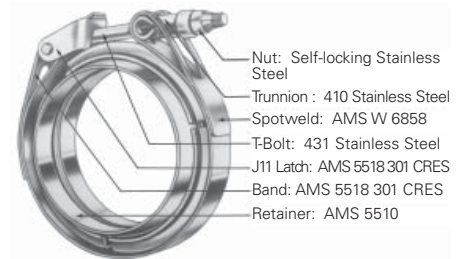
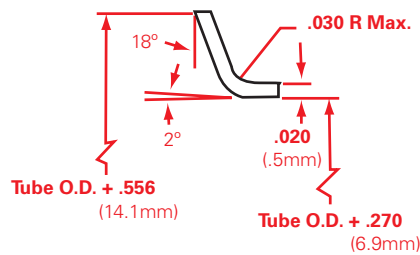

Gasket Material	Ordering Code	Temperature
Aluminum	-A	+ 500 °F + 260 °F
Copper (Nickel Plated)	-C	+750°F +399°C
Nickel	-N	+1000°F +528°C

Eaton Corporation
Fluid Conveyance
Rt. 2, Box 361
Meadowbrook Road
Eastanollee, Georgia 30538
Phone: (706) 779-3351
Fax: (706) 779-2638
www.aerospace.eaton.com

Eaton Corporation
Fluid Conveyance
300 South East Avenue
Jackson, Michigan 49203-1972
Phone: (517) 787-8121
Fax: (517) 787-5758

Eaton Corporation
Fluid Conveyance
2500 W. Argyle St.
P.O. Box 1845
Jackson, Michigan 49202-1845
Phone: (517) 787-8121
Fax: (517) 789-4716

Eaton Aerospace
Fluid Conveyance
11642 Old Baltimore Pike
Beltsville, Maryland 20705
Phone: (301) 937-4010

Eaton Aerospace
Fluid Conveyance
15 Pioneer Ave.
Warwick, RI 02888
Phone: (401) 781-4700

Eaton LTD
Fluid Conveyance
Broad Ground Road
Lakeside
Redditch
Worcs B98 8YS
England
Phone: (44) 152-751-7555
Fax: (44) 152-751-7556

Eaton LTD
Fluid Conveyance
Chemin De Pau
64121 Serres-Castet
France
Phone: (33) 559-333-864
Fax: (33) 559-333-865

Eaton Aerospace
Fluid Conveyance
2 Rue Lavoistier BP 54 78310
Coignieres, France
Phone: +33 1-30-69-3000

Eaton LTD
Fluid Conveyance
Posttach 1026
Carl-Benz-Strasse 9
D-82205 Gilching
Germany
Phone: (49) 810-575-0
Fax: (49) 810-575-27

